

**GPS Vehicle Tracker
(GPS+GSM+SMS/GPRS)**

MODEL: SPK-TRACKER-V001



Preface

Thank you for purchasing the tracker. This manual shows how to operate the device smoothly and correctly. Make sure to read this manual carefully before using this product. Please note that specification and information are subject to changes without prior notice in this manual. Any change will be integrated in the latest release. The manufacturer assumes no responsibility for any errors or omissions in this document.

1. Product packaging accessories:

- 1.1 power 4P line 1pc (standard accessory)
- 1.4 electric relay 1pc (optional accessory)
- 1.5 User manual 1pc (standard accessory)

(Accessories products refer to the actual product)

2. Product features:

- 2.1 GSM four frequency(GSM850/900/1800/1900MHZ) system global general;
- 2.2 built-in switching power supply, exceed wide voltage input range: 9-75 VDC;
- 2.3 GPS continuous GPS positioning, GPRS report regularly;
- 2.4 Support SMS message to check the location info;
- 2.5 built-in vibration sensor, realization vehicle anti-theft intelligently;
- 2.6 ACC the ignition signal detection,vehicle status prompted;
- 2.7 waterproof designed
- 2.11 built-in backup battery, realize the illegal cut the line alarm;

Content	Specs.
Dim.	68mm x 40mm x 20mm
Weight	90g
Network	GSM/GPRS
Band	850/900/1800/1900Mhz
GPS chip	UBLOX
GPS sensitivity	-159dBm
GPS accuracy	10m
Time To First Fix	Cold status 35-80s Warm status 35s Hot status 1s
voltage input	9—75V input
Battery	Build-in 3.7V 370mAh Li-ion battery
Storage Temp.	-40°C to +85°C
Operation Temp.	-20°C to +55°C
Humidity	5%--95% non-condensing

Functions:

1. GPS and Location Based Service

Location Based service also named A-GPS, when tracker in underground or tunnel ,can get location by AGPS.

2. Real time tracking

Real time tracking it by cell phone and platform . Also can support get location every 5 seconds, and the GPS accuracy is 5m .

3. Check the history of route on platform

Can check and replay within one year history of route of device ,by web monitor center

4. Power Saving Mode

The device go into standby mode when there isn't vibration for 3 minutes , it will go into working mode when it feel vibration

5. Google map on mobile

Check the location with google map on mobile.

6. Geofence and movement alert

Set up a geo-fence for the unit to restrict its movements within a district ,unit will send a message to the authorized numberwhen it breaches the district..

7. Low Battery Alarm

4. Appearance scheme

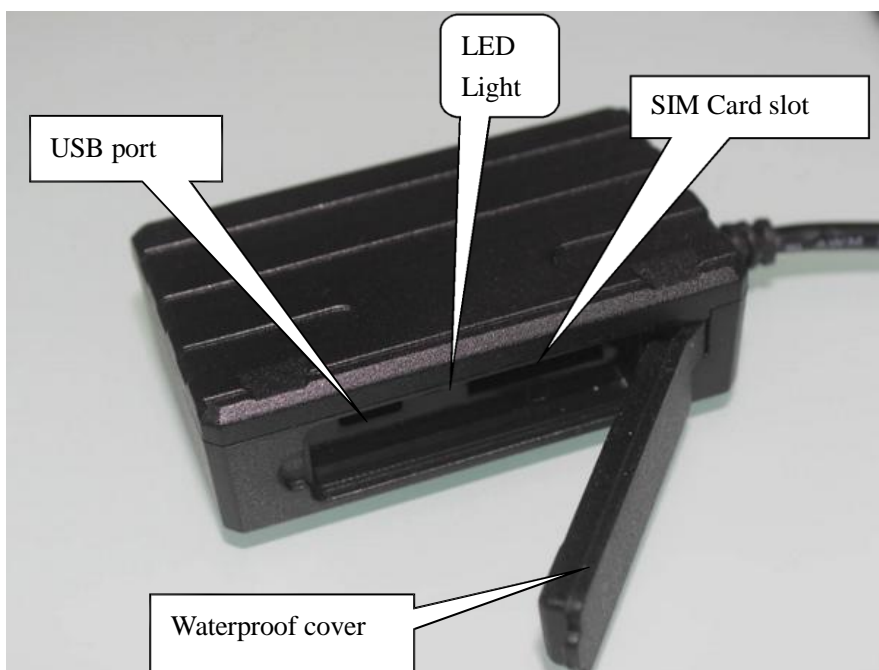

5. Preparation Installation

5.1.. Check the product

5.1.1 Open the package, and check product model and accessories. If there is something wrong or missing, please contact the distributor.

5.1.2. The selection of SIM card must follow the distributor's suggestion.

5.1.3. Install SIM card

Firstly, open the cover of the waterproof , secondly, insert the card ; finally, recover the waterproof cover

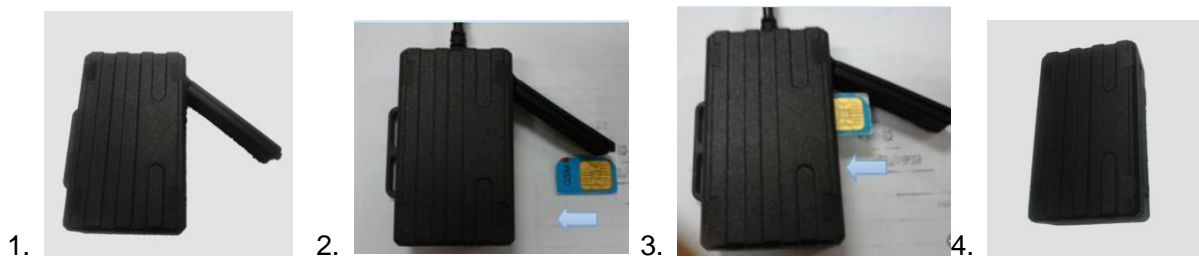

Tips:

Don't insert the SIM card up-side-down.

Make sure the SIM card with GPRS service.

If the SIM card has been inserted, but it requires you to input SIM PIN, please close the SIM PIN function under the instruction of your mobile phone user's manual.

Make sure the SIM card account has enough money

5.2. Installation

Install the tracker is hidden installation, you'd better to install it with the help of professional companies or workers authorized by the distributor. Please install it according to the following instruction.

5.2.1. To avoid the thief's destruction, the tracker should be installed in a hidden place.

5.2.2 Don't put the tracker together with the emission sources, such as the parking radar system, alarms and other vehicle-carried communication terminals.

5.2.3 You can fix the tracker with the cable tie, or glue it with wide strong sponge double-sided tapes.

5.2.4 Because the tracker has GSM and GPS antenna inside, please make sure the reception side of GPS is upward (facing the sky), and there is no metal shelter above the tracker.

Suggestions are as follow:

a, Hidden area under the decoration board below the front windshield or back windshield;

b, Hidden area around the front panel (with a surface made of non-metal materials);

Attention: If there is a metal insulation or a heating layer glued in the windshield, it will reduce the efficiency of GPS signal reception, and the GPS can't work well, you need to find other places to

install again.

5.4 Terminal wiring diagram

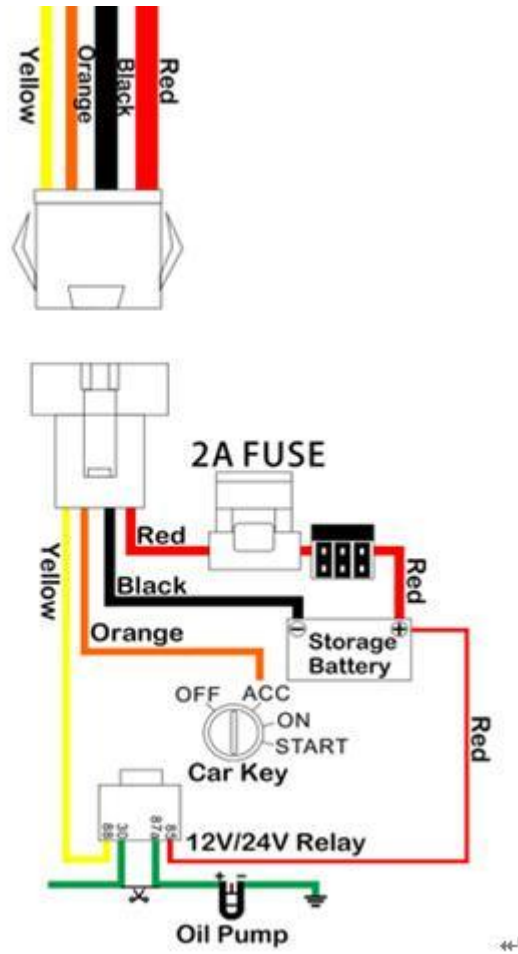

Relay connected

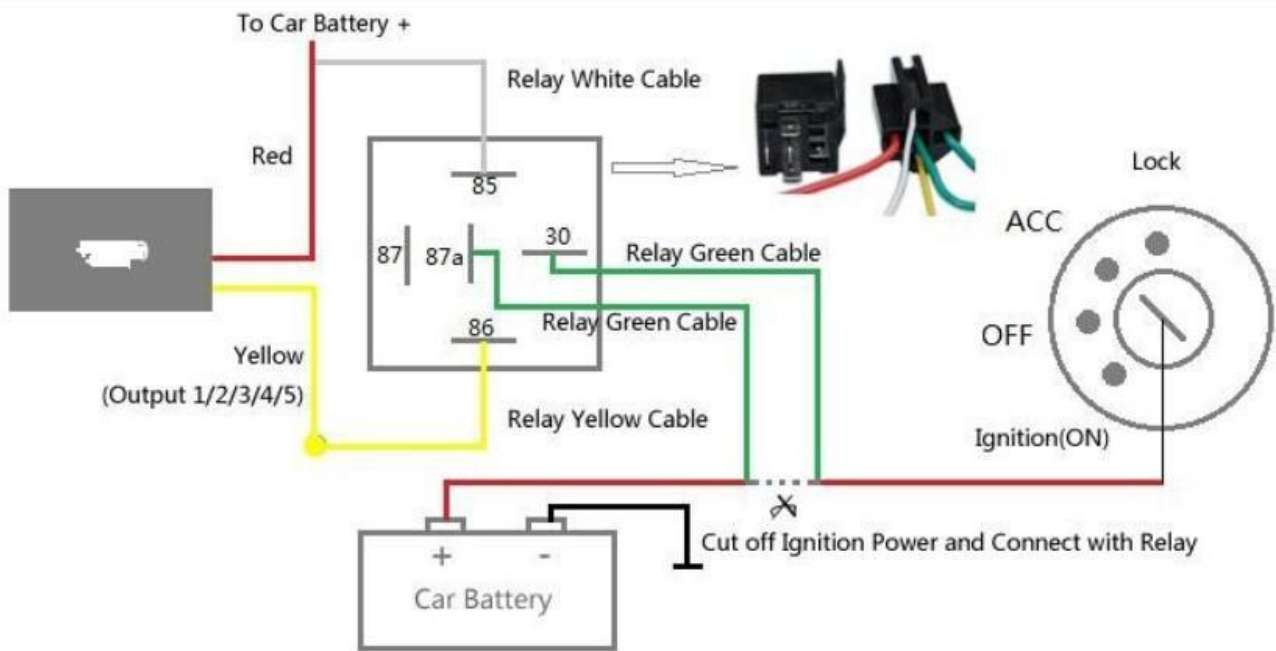

6. Equipment connect the matters needing attention

Power supply, the original car guard against theft, broken oil and electricity control line (4 pin)

6.1 This equipment is standard for power supply 10V-75VDC, please choose the original provide power supply cord, red line power positive, the black line for power negative; When installation, please choose to separate negative power grounding wires or by iron, don't and other ground were answered

6.2 The original car security line (Orange line)

7. Terminal parameter setting

Message set data: The car owner's mobile phone No. send the message code to the SIM card of the GPS device. Separated symbols is comma. The commas of the following functions data setting command is the English input format.

7.1 Basic operation Settings

7.1.1 Special No. setting (i.e., the owner number) :

Special No. is the alarm No. You can send the command of adding special No. message to terminal for adding the No. Under the status of alarm, the terminal will send the position message to the setting special No. and call the No. repeat till the phone is connected.

7.1.1.1 Add the special No.:

Command format: adm+ code+ comma+NO. e.g.: adm123456,138*****

Reply message: ADM! A1: 138*****

7.1.1.2 Delete special number:

Command format: noadmin+ code+ comma e.g.: adm123456,

Reply message: ADM! A1:

7.1.2 Modify the terminal password: please remember the password, if forget available owner send factory default command center number

The default terminal password: 123456

Command format: pwd123456 666888(666888 for the new password,must be 6 to digital)

Reply message: OK! New password: *****. Safe keeping!

P.S.: the following instructions will send can achieve center number, be sure to keep in mind

7.2 Anti-theft alarm location query set

7.2.1 Location query

Command format: G123456# or where

Reply message: <DateTime:10-11-18 18:41:04>

<http://maps.google.com/maps?q=N22.540885,E113.951341>

7.2.2 Removal and fortify

7.2.2.1 Fortified Command format: SF or 111

Reply message: GSM:A/B/C/D. POWER:X. Arm delay in XXS!

7.2.2.2 Removal Command format: CF or 000

Reply message: GSM:A/B/C/D. POWER:X. DISARMED!

P.S.: The GSM signal 0 is no signal

7.2.3 Rest for 10 minutes automatic fortification (default open)

7.2.3.1 Open Command format: auto1

Reply message: Auto arm by Standby 10 mins: ON

7.2.3.2 Close Command format: auto0

Reply message: Auto arm by Standby 10 mins: OFF

Spd:XXXkm/h 2013-07-11 21:54:33

7.2.5 Vibration alarm setting

Continuous vibration time for 3 seconds by default,vibration alarm time interval 5 minutes by default

Alarm way: 1 = SMS, 2 = phone call, 3 = SMS + Call , 0 = closed

Command format: vib2,3

Reply message: OK! Vibration Level:X Alarm mode: Call/SMS/Call & SMS

Alarm content: Vibration! Please check it now! Lat: Lon: GPS:A/V 2013-07-20 16:23

7.2.6 Shift alarm setting(default open)

7.2.6.1 Open Command format: move300

Reply message: OK! Move alarm: on

7.2.6.2 Close Command format: move0

Reply message: OK! Move alarm:OFF

7.2.7 Over speed alarm(default close)

7.2.7.1 Open Command format: spd080

Reply message: OK! Over speed alarm: km/h

7.2.7.2 Close Command format: spd0

Reply message: OK! Over speed alarm: off

Over speed alarm content: Over speed alarm!

<http://maps.google.com/maps?q=22.53908%2c113.90871> Spd:XXXkm/h 2013-07-11 21:54:33

P.S.: set the range value of 050-300, speed limit 3 digits, the unit is km/hour

7.2.8 Oil outage & power outage

7.2.8.1 cutting off the oil

Command format: 555

Reply message: CUT OIL OK!

7.2.8.2 opening the oil

Command format: 666

Reply message: RESUME OIL OK!

When the car is stolen, the monitor platform will send the command of Oil cut-off power outages.

For keeping the car safe drive the oil of the stolen car is cut off and the car can not be started.

P.S.: In order to keep the car safe, the terminal is only under GPS effective position status and make sure the car is less than 20km/h or the car is still, the oil outage and power outage can be operated .when the theft alarm is relieved, the monitor platform restore the oil & power command, the terminal recover the oil & power and you can go on driving the car.

P.S.: Make sure to set the special No. before achieving this function

7.3 Equipment to restore the query set

7.3.1 Recover the factory setting:

Command format: format

Reply message: The tracker will immediately restore the factory settings. All previous settings will be canceled.

7.3.2 GPS re-start:

Command format: RST

Reply message: The tracker will immediately restart!

7.4 commands list(pls note 123456 is the default password)

Feature name	Active command	Reply	Cancel command	reply
--------------	----------------	-------	----------------	-------

Begin(blank before set)	Begin123456	Begin ok		
Admin number	Admin123456+space+number	Admin ok	Noadmin123456+space+number	Noadmin ok
Password	Password123456+space+new	Password ok		
Sever ip&port	Adminip123456+space+ip+space+port	Adminip ok		
APN	Apn123456+local apn content	Apn ok		
LBS	Addjz=1	Open LBS	Addjz=0	Close LBS
GPRS	Gprs123456	Gprs ok	Nogprs123456	Nogprs ok
Time Zone	Timezone123456+space+8	Timezone ok	Timezone123456+space+-8	Timezone ok
Language	Lag1	Switched to english		
Restore factory setting	format	No reply		
Upload frequency(10-600s)	Upload123456+time	Upload ok		
Sleep working mode	Sleep123456+space+time	Sleep time ok	Wake up by sms,call,press button	
Shock working mode	Sleep123456+space+shock	Sleep shock ok	Wake up by shock,sms,call,press button	
No sleep working mode	Nosleep123456	Nosleep ok		
Get location	Where or G123456#	Google map link		
Shock alarm	Shock123456	Shock ok	Noshock123456	Noshock ok
Shock call alarm	vibcall123456	Shock call alarm ok		
Shock sms alarm	vibsms123456	Shock sms alarm ok		
Move alarm(distance:100-5000m)	Move123456+space+distance	Move ok	Nomove123456	Nomove ok
Overspeed alarm(50-120km/h)	Speed123456+space+max speed	Speed ok	Nospeed123456	Nospeed ok
Set a geo-fence	stockade+123456	stockade ok	nostockade12345	Nostockade ok

(stockade)	+space+long,lat;long,lat		6	
Check setting of device	Param1	Software version,date,imei,ip&port,apn,web platform	Param2	Admin number,sos number,move distance,speed,etc
Status of device	status	Bat:4,gprs:1,gsm:3,gsm:1,acc:0,oi1:0,power:1,s:0		

7.5 Web platform and sever ip&port

Website	Sever IP	Port
www.lkgps.net	101.1.16.228	7700

8.App download

8.1 android version: scan below QR code



8.2 ios version: search “LKGPS” in app store

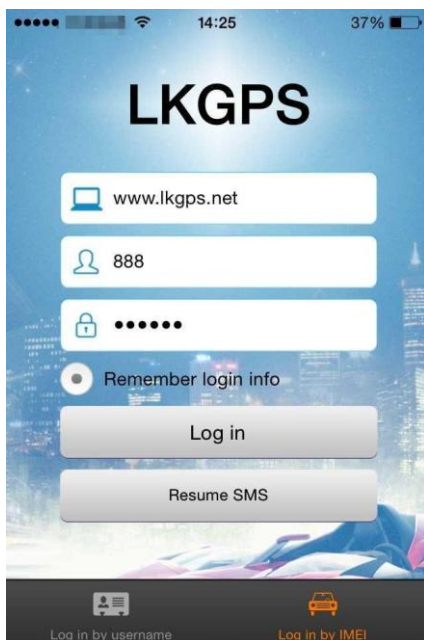

9. Faults & The solutions

Faults	Solution
Startup Fail	Check the battery and see if it is fully charged or correctly installed.
Hang up Fail	In existence of an authorized number, an unauthorized number dials up the unit. Please initialize the unit and re-set up the authorized numbers.
Monitoring failure	Please check the authorization number is set to the correct time
No GSM Signal	Please make sure SIM Card is GSM Net and installed correctly; also call display should be on; but no call transfer and PIN code off.